



ALL WEATHER  
ARCHITECTURAL ALUMINUM

## SERIES 8000 SLIDING DOOR SYSTEM

777 Aldridge Road | Vacaville, CA 95688 | P: 707.452.1600 | [www.allweatheraa.com](http://www.allweatheraa.com)

# SERIES 8000

## SLIDING DOOR SYSTEM

The Series 8000 Sliding Door System is one of All Weather's most innovative, durable and energy efficient door designs. Enhance how you experience the world around you by opening an entire wall with the Series 8000 sliding door's massive 8 panel, 12' tall configuration.

Held to the highest standards of quality and performance, the Series 8000 features 3" stainless steel precision bearing rollers for smooth operation, multiple thermal breaks for increased energy efficiency and boasts robust build quality. The Series 8000 sliding door is the perfect choice for commercial projects and high end custom residential applications.

### FEATURES

- Max panel height of 144" tall and min panel height of 46"
- Max panel width of 96" and min panel width of 32"
- Max panel size of 70 square feet
- Up to 8 active panels, up to 4 tracks
- Thermally broken frame – Thermal Strut system
- Standard Extruded Quanex, optional Centor retractable screen available
- Square cut corners, mechanically fastened
- 6063 extruded aluminum age hardened to a T-6 rating for strength and durability

### FRAME & SILL OPTIONS

- 2" Sill
- Nail On or Equal Leg
- Block Frame

### CONFIGURATIONS

- XO, OX
- XXO, OXX
- OXO, XOO, OOX
- OXXO
- OXXXXO

### GLAZING OPTIONS

- 1" OA insulated glass
- 1" Simulated Divided Lite (SDL) – Flat bar
- 2 1/8" True Divided Lite (TDL)
- Marine glazed
- Enhanced Noise Reduction (STC)

### HARDWARE OPTIONS

- Flush mount or modern D pull handle
- 3" Stainless Steel rollers
- 1.8 Stainless Steel rollers for panel widths of 22" - 26"

### FINISH OPTIONS

- Clear Anodized, Class I (standard)
- Bronze Anodized, Class I (standard)
- Kynar Paint (color matching available)
- Split finishes options for interior and exterior

### RATINGS & CERTIFICATION

- Up To .30 U-Values Achievable
- Commercial Rating C30
- Acoustically Rated

Assembly Drawings

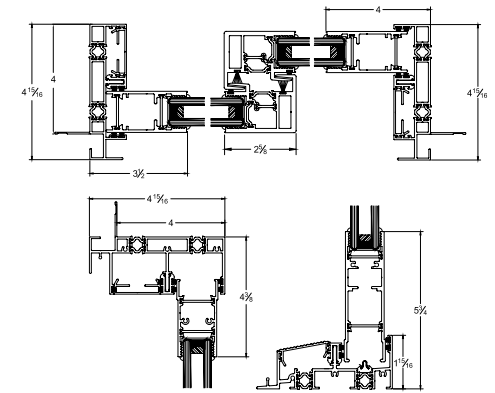

3" Rollers

